



REVOLUTION X UNLIMITED

START GUIDE

Microsoft, Xbox "Sphere" Design, Xbox, Xbox Series X, Xbox Series S, Xbox Series X|S, Xbox One, Game Pass and Windows 10/11 are trademarks of the Microsoft group of companies. All other trademarks are the property of their respective owners.

© 2025 NACON
Made in China



Thank you for purchasing this NACON® product.

This product has been designed to enhance your gaming experience. Please keep this user manual in a safe place for future reference.

I CONTENTS



**Revolution X
Unlimited**



Storage case



**Accessory
storage box**

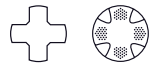

2 D-pads

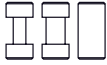

6 Weights
(2x 10g, 2x 14g, 2x 16g)



Charging station



3m USB-C cable



6 Joystick heads
(2 concave, 4 convex)



USB dongle



Metal joystick rings
(2x 30°, 2x 38°)



Quick Start Guide

I RATING LABEL

To see the rating label information, remove the back plate of the controller.

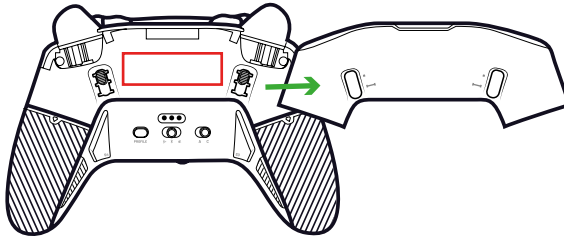

I ADDITIONAL INFORMATION

Controller dimensions: 164x115x56mm

Charging stand dimensions: 92x86x50mm

Controller weight: 327g

Charging stand weight: 87g

Controller Input: 5V \equiv 1500mA

Charging stand current Input: 5V \equiv 1500mA

Please note: To improve your gaming experience, we are likely to publish firmware (also called micro-software) updates through the Revolution X Unlimited application available on the Microsoft Store. Check the application regularly for the latest updates.

I CONTROLLER ELEMENTS

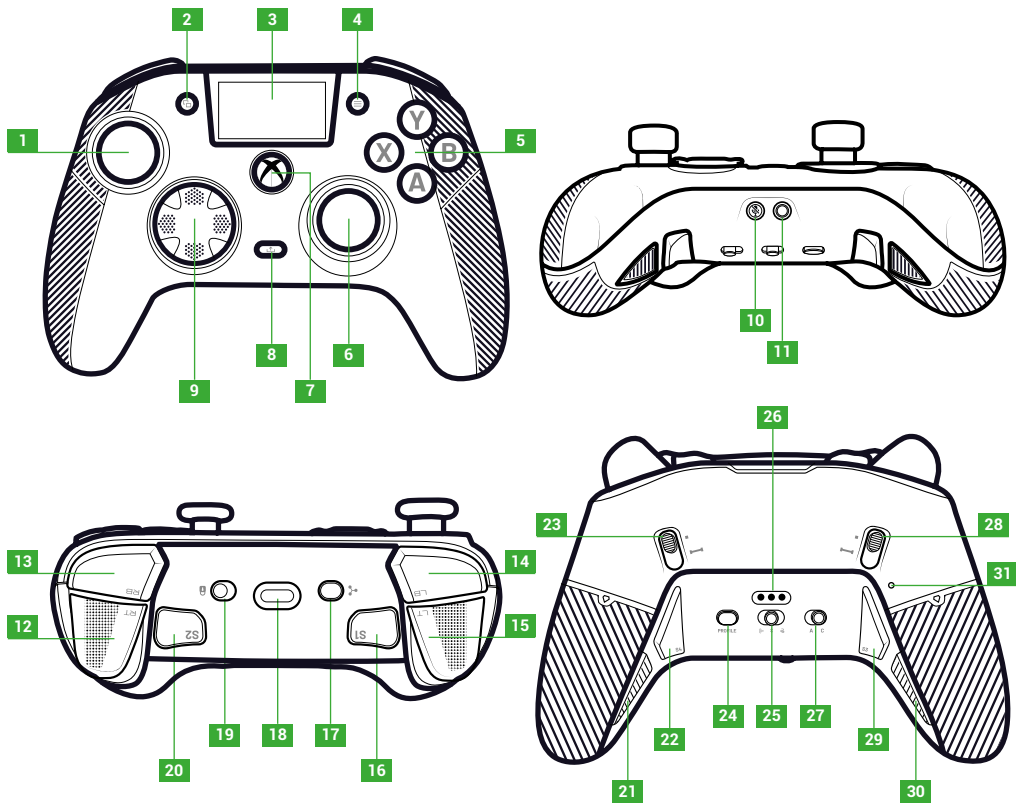

1. Left joystick
2. View button
3. Screen
4. Menu button
5. Action button
6. Right joystick
7. Nexus button
8. Share button

9. D-pad
10. Mute button
11. 3.5mm jack socket
12. Right trigger (RT)
13. Right shoulder (RB)
14. Left shoulder (LB)
15. Left trigger (LT)
16. Shortcut 1 (S1)

17. Multi-function button
18. USB-C Socket
19. Lock button
20. Shortcut 2 (S2)
21. Shortcut 4 (S4)
22. Shortcut 6 (S6)
23. Right instant trigger blocker
24. Profile button

25. Mode button (wired, Bluetooth®, wireless 2.4GHz)
26. Charging pin
27. Classic/Advanced mode button
28. Left instant trigger blocker
29. Shortcut 3 (S3)
30. Shortcut 5 (S5)
31. Reset hole

I INSTANT TRIGGER BLOCKERS

With the instant triggers, you can turn each trigger into an instant button.

ACTIVATE OR DEACTIVATE THE INSTANT TRIGGER BLOCKERS

1. Press the button once. The button unlocks.
2. Press and hold the button.
3. Slide the button up to activate the blocker, or down to deactivate it.

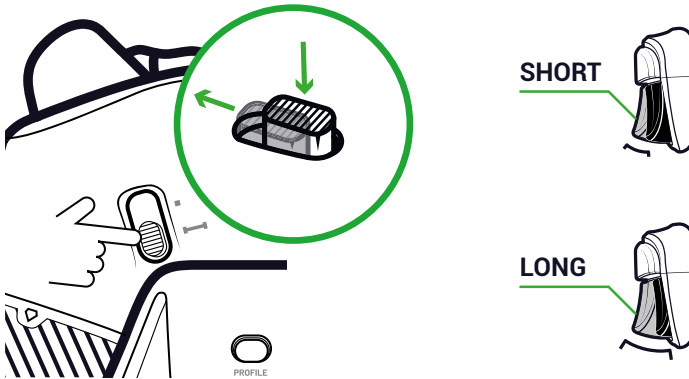

LOCK BUTTON

You can use the **Lock** button to deactivate the **Menu** and **View** buttons. This prevents you from accidentally pressing these buttons while you play.

I CHARGE THE CONTROLLER

There are two methods to charge your controller.

CLASSIC CHARGING (AROUND 7H):

Connect the charging station to your gaming device (Xbox or PC) and put your controller in position. The controller automatically starts charging and the status displays on the controller's screen.

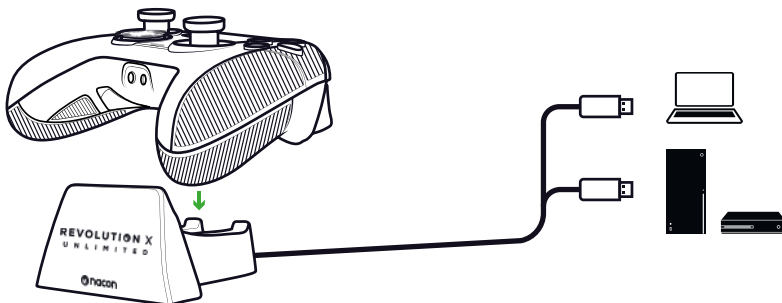

FAST CHARGING (AROUND 3H):

Connect your controller directly to your Xbox or PC with the USB cable supplied. The controller automatically starts charging and the status displays on the controller's screen.

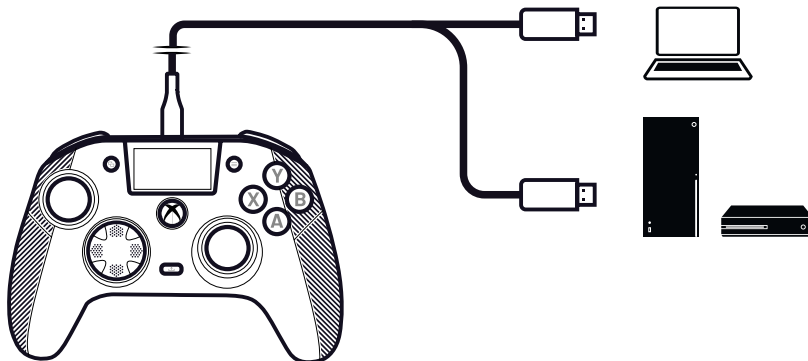

When you power on the controller, the controller's screen displays the battery level next to the battery icon.

I DO A FULL RESET OF THE CONTROLLER

If you need to do a full reset use a paper clip to activate the button inside the **reset hole** located on the rear of the controller.

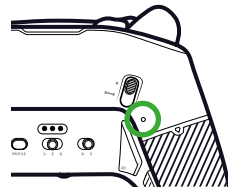

I USE THE REVOLUTION X UNLIMITED APPLICATION

With the Nacon Revolution X Unlimited application, you can do a deep customization of your controller. The application is available on Xbox and PC on the Microsoft store, free of charge.

1. In the Microsoft store search bar, type "Revolution X Unlimited".

2. Download the application.

NOTE: Make sure not to download the application "Revolution-X", this is not compatible with this controller.

3. Connect the controller to your PC.

4. Set the controller to the modes that follow:

- **Wired** mode.
- **Xbox** mode.
- **Advanced** mode.

5. Launch the application.

6. Follow the instructions on screen to personalize your profile.

I XBOX AND PC MODES

The Revolution X Unlimited controller is an Xbox controller and is compatible with PC. To set your controller to **Xbox** mode or **PC** mode, press the **Multi-function** button.

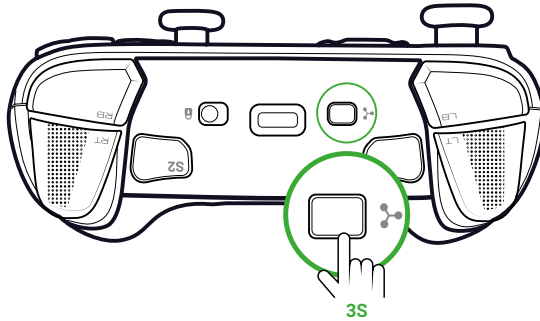

The interactive screen displays the controller icon in the top left corner. The interface is green in **Xbox** mode and purple in **PC** mode.

XBOX

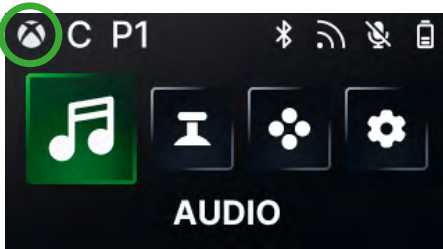

PC

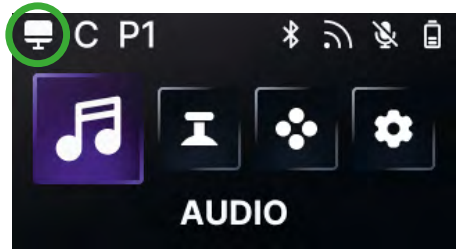

XBOX MODE

In **Xbox** mode, you can use your controller as an Xbox controller on both Xbox and PC. By default, the latency is fixed at 4ms to match console requirements. You cannot change it.

PC MODE

In **PC** mode, the Xbox does not recognize the controller. You can only use it on PC. To switch in PC mode your controller must not be plugged into your Xbox, if it is connected to it the switch will not happen.

You have access to all the features available in **Xbox** mode and to three new features that are only available on PC:

- You can decrease the latency to 1ms in **Wired** mode and 2ms in **Wireless** mode.
- You can activate gyroscopic features.
- With the application, you can map the shortcuts to keyboard keys.

I LATENCY (PC ONLY)

CHANGE THE LATENCY

By default, the latency of your controller is set to 2ms in **Wireless** mode and 1ms in **Wired** mode.

With the application, you can change the latency of your controller. This feature is only available in **PC** mode.

1. Click **"PC"**
2. Click **"Communication speed"**

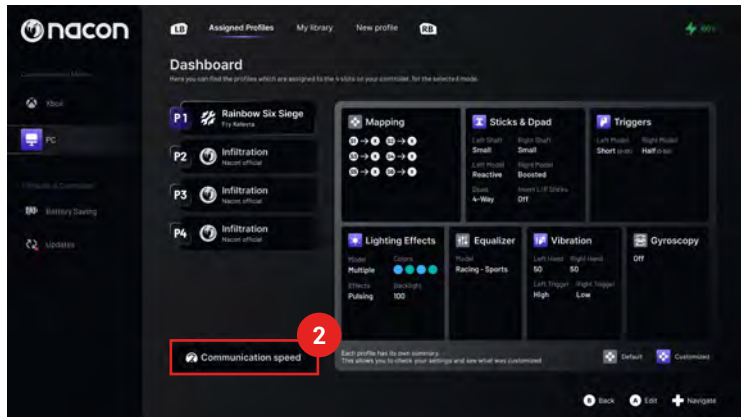
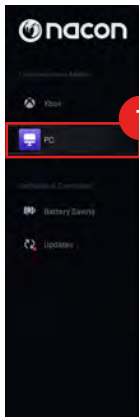

3. Select a speed: **"Normal"**, **"Reactive"** or **"Boosted Wired mode"**
4. Click **"Confirm"**

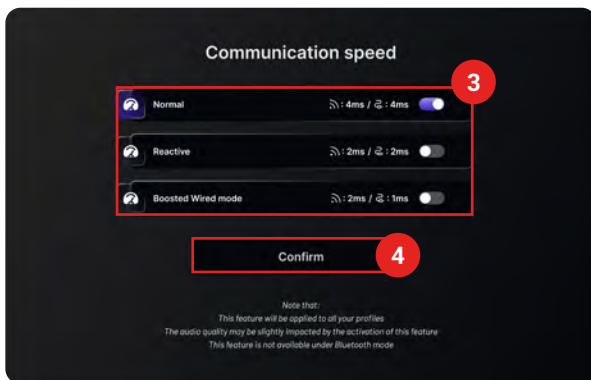

Milliseconds/hertz
conversion

mS	Hz
1	1000
2	500
4	250

I CLASSIC AND ADVANCED MODES

Your controller has two modes: **Classic** and **Advanced**.

To change the mode, use the **Classic/Advanced** mode button on the back.

- To set the controller to **Classic** mode, slide the button to **C**.
- To set the controller to **Advanced** mode, slide the button to **A**.

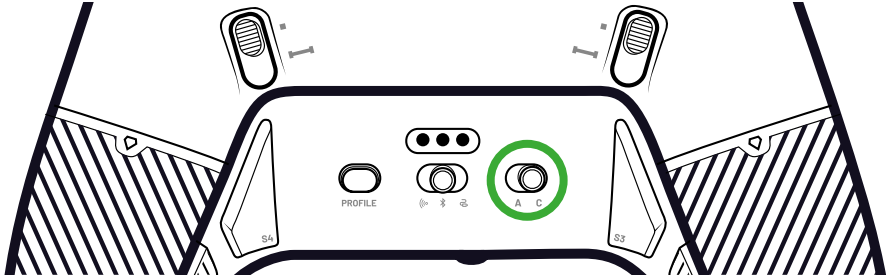

CLASSIC MODE

In **Classic** mode, the controller operates like a usual Xbox or PC.

- You can use the interactive screen to customize the controller settings locally.
- To customize the controller settings, the application is not necessary.
- You can customize a maximum of twelve profiles
(See the Profiles in **Classic** mode section for more information).

ADVANCED MODE

In **Advanced** mode, you can do a deeper setup customization.

- You can use the application to customize all the controller settings and the profiles.
- You can customize a maximum of eight profiles
(See the Profiles in **Advanced** mode section for more information).

I PROFILES

You can have access to a total of twenty profiles.

To switch between your profiles, press the **Profile** button.

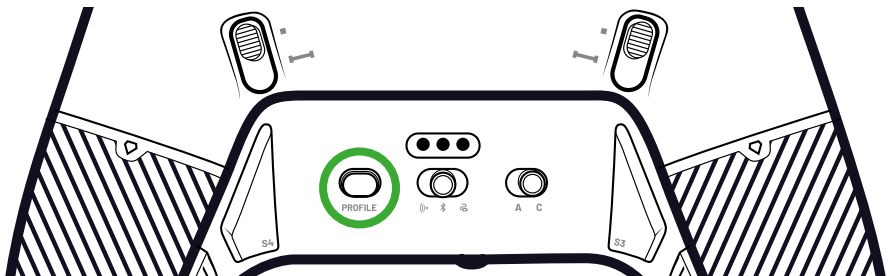

PROFILES IN CLASSIC MODE

In **Classic** mode, you have access to twelve profiles:

- Four for Xbox.
- Four for PC.
- Four for Bluetooth®.

You can use them if you want a gaming experience with a quick and easy setup and if you do not want to use the application. You can only change them locally with the screen.

PROFILES IN ADVANCED MODE

In **Advanced** mode, you have access to eight profiles:

- Four for Xbox.
- Four for PC or Bluetooth®.

You can use them if you want a gaming experience with a deeper setup customization. To use them, the Xbox or PC application is necessary.

I USING THE CONNECTION MODES

WIRED MODE

1. Connect the controller to your gaming device (Xbox or PC).
2. Set the **Mode** button to **Wired**.
3. Press the **Nexus** button.

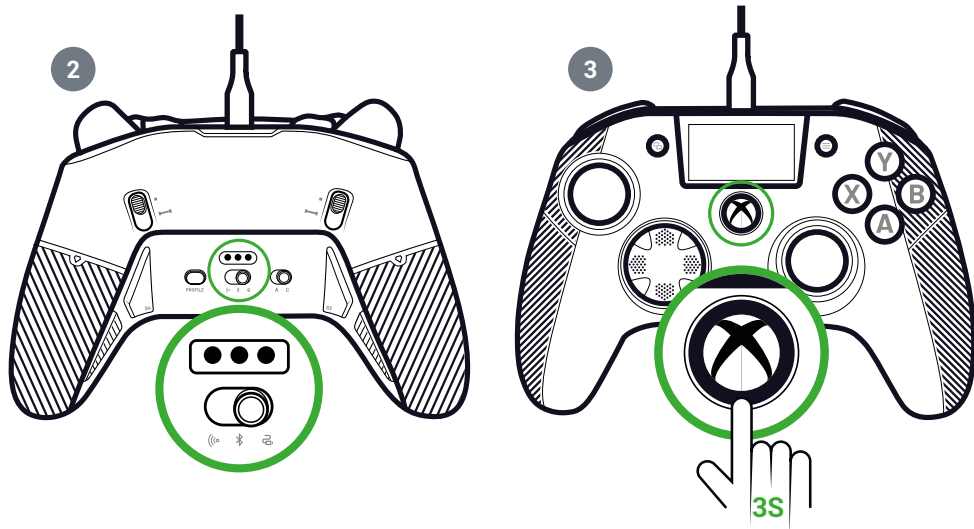

I USING THE WIRELESS MODE (DONGLE)

In wireless mode, a dongle is necessary.

1. Connect the dongle to your gaming device (Xbox or PC).

A OR B

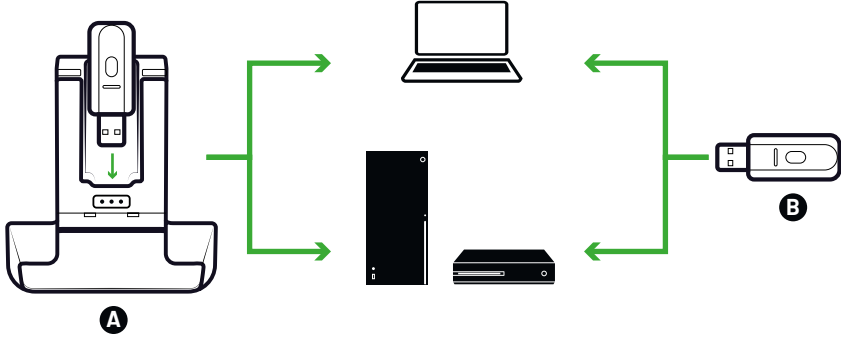

2. Set the **Mode** button to **Wireless**.

3. Press the **Nexus** button.

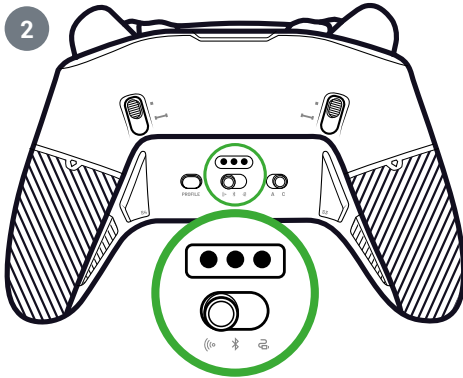

I PARING (DONGLE)

If you have a new dongle or if you lose the connection, you can pair the controller to the dongle again.

1. On the interactive screen, go to **Settings**  > **Pairing**  > **Dongle** .

2. Press the dongle button.

A successful connection message displays.



I USE THE BLUETOOTH® CONNECTION

When you set the controller to **Bluetooth®** mode:

- The audio and the vibration features are unavailable because of the limitations of the Bluetooth® protocol.
- You can only use the controller with devices compatible with the Android operating system.

FOR GAMING

1. Set your gaming device to pairing mode.
2. Set the **Mode** button to **Bluetooth®**.
3. Press the **Nexus** button.
4. Press the **Multi-function** button. *The interactive screen activates.*
5. Go to **Pairing** . The pairing process begins and a successful connection message displays.

TIP. If you want to quickly turn off your controller when you are in Bluetooth® or radio frequency mode, you can set the **Mode** button to **Wired**. The button turns off the controller immediately.

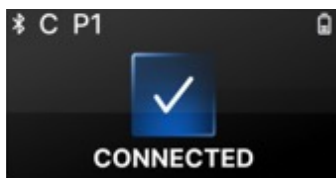



FOR AUDIO MIXING

When you set the controller to **Wired** or **Wireless** (dongle) mode, you can have a dual connection. This feature mixes two audio sources together:

- The one that comes from your gaming device;
- The one that comes from a Bluetooth® device (for example, a mobile phone) connected to your controller.

Then, the two audio sources are sent to the jack socket of the controller.

1. Set your gaming device to pairing mode.
2. Set the **Mode** button to **Wired** or **Wireless**.
3. Press the **Nexus** button.
4. Press the **Multi-function** button. *The interactive screen activates.*
5. On the interactive screen, go to **Settings**  > **Pairing**  > **Bluetooth** . The pairing process begins and a successful connection message displays.

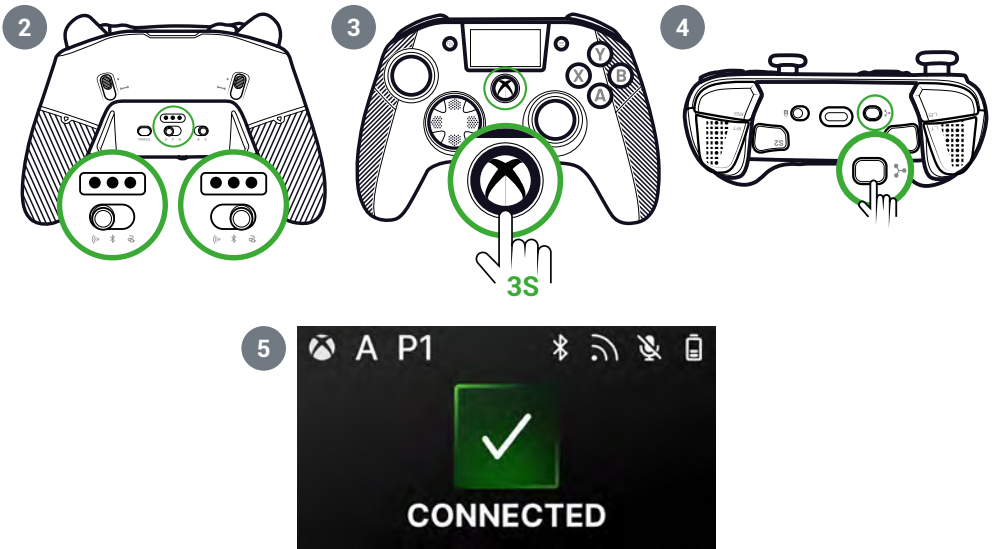

I INTERACTIVE SCREEN

The interactive LCD screen displays information on the status of your controller and lets you do local customization without having to use the application.

USE THE SCREEN

The interactive LCD screen displays information on the status of your controller and lets you do local customization without having to use the application.

1. To activate or deactivate the screen, press the **Multi-function** button.
2. To navigate the screen, use the D-pad and the **A** and **B** buttons.

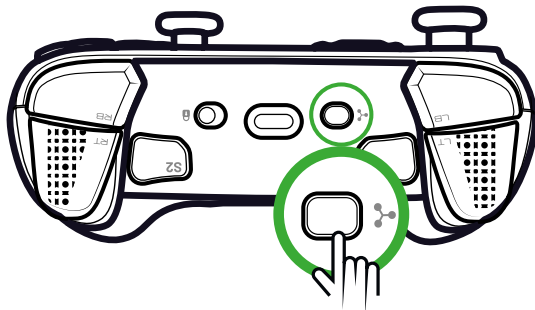

INFORMATION AVAILABLE ON THE SCREEN

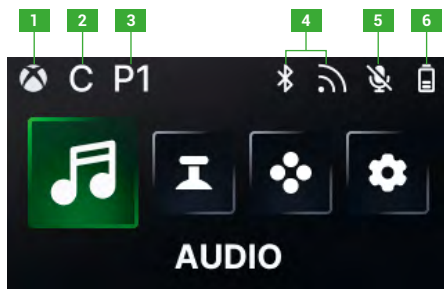

1. Xbox or PC controller mode
2. Classic or Advanced mode
3. Selected profile
4. Bluetooth® or 2.4GHz wireless mode
5. Microphone status
6. Battery level

I CHANGING SETTINGS USING THE SCREEN

With the screen, you can change all the settings that follow.

AUDIO

You can change the audio in **Wired** or **Wireless** (dongle) mode when you connect a wired headset to the controller.

- **Volume:** Change the volume of your wired headset.
- **Mic gain:** Increase or decrease the gain of the microphone of your wired headset.
- **Game chat mixer:** Adjust the game chat wheel of your Xbox.
- **Mixing:** Adjust the audio mixing between the audio coming from your console and the audio coming from your paired Bluetooth® device. With this option, you can listen to music or a video that comes from your mobile phone while you play.
NOTE: You cannot use the mixing option for your microphone because the data only goes to the gaming device.

If your controller is in **Bluetooth®** mode, the audio options on the screen are deactivated.

JOYSTICKS

You can customize the behavior of your joysticks:

- Change the response curve of your joystick with the preset settings. If you want to do your own joystick curve, use the PC/Xbox application and set the controller to Advanced mode.
- Invert the joysticks.
- Adjust the dead zone.
- Activate or deactivate the **Shooter Pro** mode. This mode removes the deadzone on the joystick that you selected. It is recommended for shooting games.
- Activate or deactivate the **Sensitivity +** mode. This mode gives you access to more data into the diagonals so that you can go faster on screen.
- Reverse the Y axis:
 - In **PC** mode only, you can activate or deactivate the Gyroscope mode. In this mode, the 6-axis chipset of the controller emulates the movement of one of the two joysticks or the D-pad. You can choose if you want to emulate the left or right joystick or the D-pad with the spatial movement of your controller.
 - In **Advanced** mode, you can only choose if you want to activate the Gyroscope mode or not. To adjust the dead zone or set the gyroscope to the D-pad or joysticks, you must use the application.

MAPPING

Mapping in Classic mode

- You can map shortcuts to any button of your controller.
- If you want to remap a shortcut after setting it, you can change it on the screen locally.
- You can use preset profiles for your shortcuts, but you cannot save them.

Mapping in Advanced mode

- You can create new profiles to save your shortcuts.
- In PC mode, you can map keyboard keys to shortcuts with the application.
- If you want to change a shortcut on the screen while playing, you can only change the mapping to one of the buttons on the controller. To map another keyboard key, you must use the application.

CUSTOMIZED SETTINGS

- Activate or deactivate Bluetooth® for the dual connection in **Wired** or **Wireless** mode. The controller automatically reconnects to the latest connected device.
- Launch the pairing for the dongle or the Bluetooth® connection.
- Activate or deactivate one of the four vibrations engines independently.
- Use the **Eco** mode:
 - Activate or deactivate the **Battery saving** mode.
 - Adjust the brightness of the screen.
 - Select a time to turn off the screen automatically when not in use.
 - Select a time to reduce the screen brightness automatically.

I SUMMARY OF POSSIBLE CHANGES OF SETTINGS

Here is the summary of all the changes of settings that you can do with the interactive screen or on the app, depending on the modes of your controller.

AUDIO

	Xbox mode		PC mode		Bluetooth®	
	Classic	Advanced	Classic	Advanced	Classic	Advanced
Headset volume	Yes	Yes	Yes	Yes	No	No
Mic gain	Yes	Yes	Yes	Yes	No	No
Game chat mixer	Yes	Yes	Yes	Yes	No	No
Mixing	Yes	Yes	Yes	Yes	No	No

JOYSTICKS

	Xbox mode		PC mode		Bluetooth®	
	Classic	Advanced	Classic	Advanced	Classic	Advanced
Response curve	Yes	On app	Yes	On app	Yes	On app
Dead zone	Yes	On app	Yes	On app	Yes	On app
Shooter Pro	Yes	On app	Yes	On app	Yes	On app
Sensitivity +	Yes	On app	Yes	On app	Yes	On app
Reverse the Y axis	Yes	On app	Yes	On app	Yes	On app
Invert joystick	Yes	On app	Yes	On app	Yes	On app
Gyroscope	No	On app	Yes	Yes	No	Yes

MAPPING

	Xbox mode		PC mode		Bluetooth®	
	Classic	Advanced	Classic	Advanced	Classic	Advanced
Controller key on the shortcut	Yes	Yes	Yes	Yes	Yes	Yes
Keyboard key on the shortcut	No	No	No	On app	On app	On app

CUSTOMIZED SETTINGS

	Xbox mode		PC mode		Bluetooth®	
	Classic	Advanced	Classic	Advanced	Classic	Advanced
Battery saving mode	Yes	Yes	Yes	Yes	Yes	Yes
Screen timer off	Yes	Yes	Yes	Yes	Yes	Yes
Controller time off	Yes	Yes	Yes	Yes	Yes	Yes
Screen brightness	Yes	Yes	Yes	Yes	Yes	Yes
Dongle pairing	Yes	Yes	Yes	Yes	No	No
Bluetooth® pairing	Yes	Yes	Yes	Yes	Yes	Yes
Vibrations	Yes	Yes	Yes	Yes	Yes	Yes
Power management	Yes	Yes	Yes	Yes	Yes	Yes
Joystick curves	No	On app	No	On app	No	On app
RGB effect	No	On app	No	On app	No	On app
1000Hz polling rate	No	No	No	On app	No	On app
Gyroscope axes customization	No	On app	No	On app	No	Yes
Custom equalizer	No	On app	No	On app	No	On app
Trigger dead zone personalization	No	On app	No	On app	No	On app

I CUSTOMIZE THE CONTROLLER AND THE JOYSTICKS

CHANGE THE JOYSTICK HEAD OR DIRECTIONAL CROSS

You can replace parts of your controller and customize it with a range of accessories: joysticks, D-pad, joystick rings and hand grips.

1. Pull the joystick head or the directional cross carefully.
2. Put the new joystick head or directional cross in position.
3. Press until you hear a click sound.

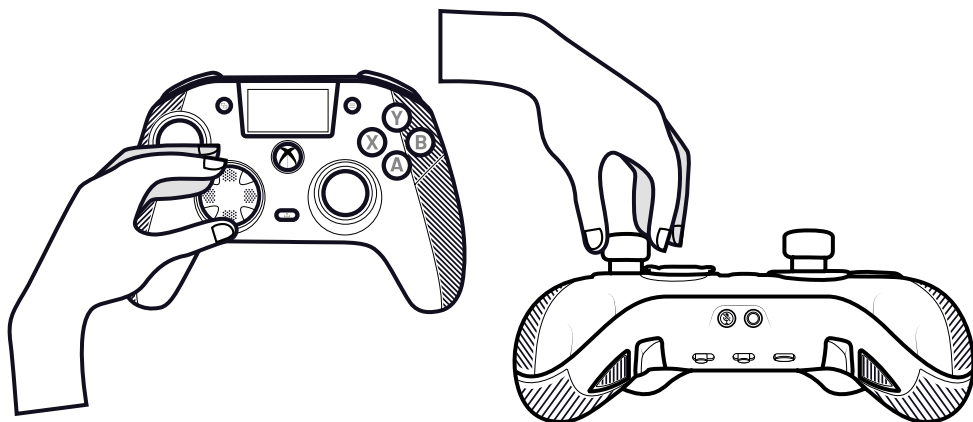

CHANGE THE METAL JOYSTICK RINGS

To get a more reactive or precise response on certain games, you can change the rings on your joysticks.

1. Pull the joystick head carefully.
2. Remove the metal joystick ring.
3. Put the new joystick ring in position.
4. Align the joystick head correctly on the top of the shaft.
5. Press until you hear a click sound.

CHANGE THE HAND GRIP WEIGHTS

1. Push and slide down the hand grip cover to remove it.
2. Insert the new weight.
3. Slide the cover back in position until you hear a click sound.

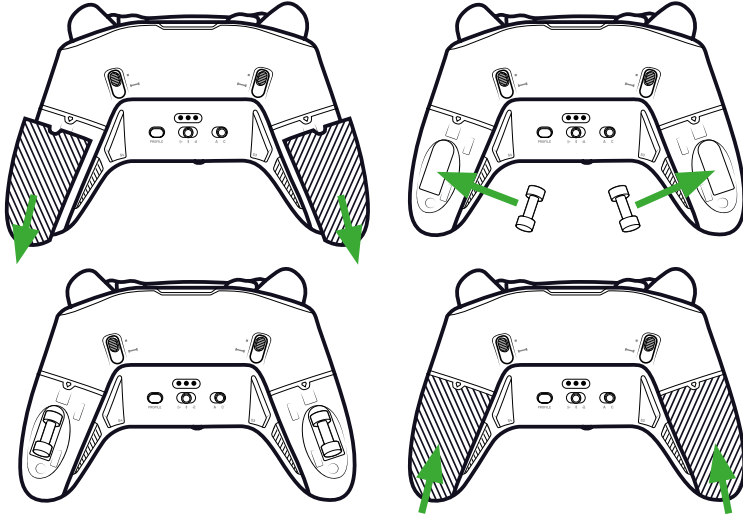

I SECURITY ISSUES

REPORT A SECURITY ISSUE

Nacon is committed to ensuring the security of its customers by protecting their personal information from unwarranted disclosure. If you feel that there is, or has been, a security issue, please contact Nacon at support@nacongaming.com with the information that follows:

- Email subject: "Security issue".
- Product name.
- Date of purchase.
- Location of purchase.
- Details of the issue.
- Where the vulnerability, or security concern, was discovered.
- The detailed description of the necessary steps to reproduce the vulnerability or security concern. This can include screenshots.

You will receive an acknowledgement of the security issue report as soon as possible and status updates until the reported security issue is solved.

MINIMUM SECURITY PERIODS

Security updates will be available for two years, from the date of purchase, up to the 31st of December 2026. This process is free of charge to the end user.

DISCLOSURE TO THIRD PARTIES

If the issue reported affects a third-party vendor or library, Nacon reserves the right to forward the relevant details to that party without giving prior notice.

I TECHNICAL SUPPORT

For any information, you can contact the support team through the form on www.nacongaming.com/contact. Make sure to complete the form correctly and in detail to speed the processing of your request.

You can also contact the support team through live chat. We are available to answer from Monday to Friday, from 9 AM to 6 PM (Paris time). Additionally, you can use our chatbot 24/7.

If you live in North America (USA, Canada, Mexico), you can also contact the support team by phone or by email.

From the USA and Canada (English, Spanish and French Canadian)

- **Phone:** 1-833-622-6687 (toll-free)
- **Email:** support.us@nacongaming.com

From Mexico (Spanish)

- **Phone:** 001-855-434-0911 (toll-free)
- **Email:** soporte@nacongaming.com

I EU Declaration of Conformity

Product: REVOLUTION X UNLIMITED for XBOX

Manufacturer: Nacon

Nacon declares that this product is in compliance with the Union harmonisation legislation:

- Directive 2014/30/EU for Electromagnetic Compatibility
- Directive 2011/65/EU the restriction of the use of certain hazardous substances in electrical and electronic equipment

The full text, of the EU Declaration of Conformity, is available at the following website: my.nacongaming.com/en-GB/support

I UK Declaration of Conformity

Product: REVOLUTION X UNLIMITED for XBOX

Manufacturer: Nacon

Nacon declares that this product is in compliance with the United Kingdom legislation:

- Electromagnetic Compatibility Regulations 2016
- The restriction of the use of certain hazardous substances in electrical and electronic equipment regulations 2012

The full text, of the UK Declaration of Conformity, is available at the following website: my.nacongaming.com/en-GB/support

I FCC: Declaration of Conformity

United states

This product complies with Part 15 of the FCC Rules. Operation is subject to the following two conditions: (1) this device may not cause harmful interference, and (2) this device must accept any interference received, including interference that may cause undesired operation.

Warning: Changes or modifications not expressly approved by the party responsible for compliance could void the user's authority to operate the equipment.

Note: This equipment has been tested and found to comply with the limits for a Class B digital device, pursuant to part 15 of the FCC Rules. These limits are designed to provide reasonable protection against harmful interference in a residential installation. This equipment generates, uses and can radiate radio frequency energy and, if not installed and used in accordance with the instructions, may cause harmful interference to radio communications. However, there is no guarantee that interference will not occur in a particular installation. If this equipment does cause harmful interference to radio or television reception, which can be determined by turning the equipment off and on, the user is encouraged to try to correct the interference by one or more of the following measures:

- Reorient or relocate the receiving antenna.
- Increase the separation between the equipment and receiver.
- Connect the equipment into an outlet on a circuit different from that to which the receiver is connected.
- Consult the dealer or an experienced radio/TV technician for help.

This equipment complies with FCC radiation exposure limits set forth for an uncontrolled environment.

I Reporting Security Issues

Nacon is committed to ensuring the security of its customers by protecting their personal information from unwarranted disclosure. If you feel that there is, or has been, a security issue then please follow this process:

1) Information on how to report security issues

Please email Nacon at support@nacongaming.com with the following information:

- Product name;
- Date of purchase;
- Location of purchase;
- Details of the issue;
- The location the vulnerability, or security concern, was discovered;
- The detailed description of the steps needed to reproduce the vulnerability or security concern which may include screen shots;

You will receive an acknowledgement, of the security issue report, as soon as practicable and status updates until the resolution of the reported security issue.

Please use the email title: `Security issue`

2) Information on minimum security periods

Security updates will be available for 2 years, from the date of purchase, up to the 31st December 2026.

This process is free of charge to the end user.

3) Disclosure to third parties

If the issue reported affects a third-party vendor, or library, then Nacon reserves the right to forward the relevant details to that party without giving prior notice.



WWW.NACONGAMING.COM

X @NaconGaming f Nacongaming ▶ Nacon International